

Code	Length	Projection
CP1028.03	20mm [0.79 in]	20mm [0.79 in]
CP1028.04	25mm [0.98 in]	25mm [0.98 in]
CP1028.05	30mm [1.18 in]	30mm [1.18 in]
CP1028.06	40mm [1.97 in]	40mm [1.97 in]

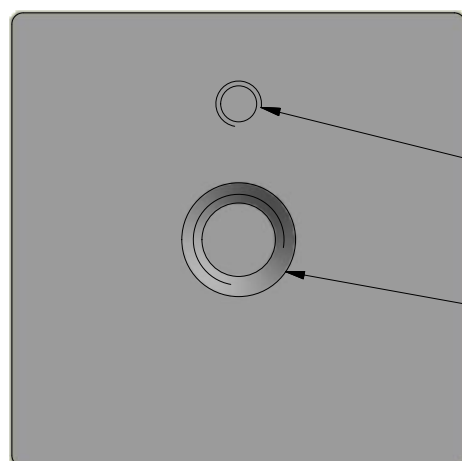

M2 anti rotation

M4 fixing